

**Chothu's**<sup>®</sup>  
Building Promoters (P)LTD

An ISO 9001-2008 Certified Company

THE  
EVERLASTING  
CREATIONS...

# EAST AVENUE

Luxury Villas

Near Chittatumukku, Kazhakoottam

Realizing Your Dream Home





# EAST AVENUE

Realizing Your Dream Home

## ABOUT US

Chothy's group of company based in trivandrum was stepped with its focus on construction couple of years ago apart from its other business activities. Today, the group has spreads its wings and continues its exploration for new and successful projects and has emerged as one of the best and fast-growing builders group in India.

We offers thoroughly professional service without forfeiting the fundamentals of honesty and integrity which form the crux of our business ethics. Our speciality is to honor customer's maximum suggestions, allow to ensure the quality of work at any stage, full freedom to visit site at any day any time. We recognize and understand each needs and every dreams of our clients and assist them in build villa, which suits their requirement and budget.

Chothy's is a technocrat-headed, system-driven group of highly qualified professionals, that swears by the values each of them have enshrined in themselves-professionalism to the core, quality that is more than a mere sales pitch and the firm belief that there is only one way to get the job done, and that is the right way.

We provide villas at a very reasonable and affordable rate to all classes of the society who believe



# EAST AVENUE

Realizing Your Dream Home

## SPECIFICATIONS

Foundation and Super Structure :	Foundation and Basement in RR Masonry. Super Structure with quality bricks in CM. M20 mix for RCC.
Flooring :	Vitrified tiles flooring in all rooms except toilets . (Johnson, Nitco, Somani or equivalent.)
Toilets :	Flooring with anti - skid ceramic tiles and glazed tiles dado up to a height of 210 cm. Good quality white sanitary fixtures (Parryware, Hintware or equivalent) and CP fittings (Omco or equivalent). Hot & cold water mixer tap with shower and provision for fixing wall mounted geyser in toilets.
Kitchen :	Kitchen platform with granite counter top and Stainless Steel sink with single bowl . Glazed dado above granite counter top up to a height of 50 cm.
Doors :	Teakwood paneled door entrance, Back door frame and shutter in seasoned wood and Molded flush door with hardwood frame for all the other doors.
Windows :	Hardwood frame with MS rod grill and glazed shutters for windows.
Painting :	Interior: Plastic emulsion over putty finished surface. Exterior: Good quality antifungal weather proof exterior paint. Wood work and grill work with enamel paint. (Asian, Berger or equivalent).
Electrical :	Independent 3 phase KSEB connection with MCB & RCCB, concealed copper wiring , adequate light & Fan points and Power Points with modular Switches.( Havels, R R or equivalent) Provision for split A/c in Master Bed Room.
Water Supply and Drainage :	Independent Water connection & drainage system.



# EAST AVENUE

Realizing Your Dream Home

Type- A - 2000 Sft



- Dimension may vary slightly during construction.
- Furniture and fixtures are indicative only.
- All Dimensions are in centimeters.



Type- A - 2000 Sft  
Ground Floor



Type- A - 2000 Sft  
First Floor

# EAST AVENUE

Realizing Your Dream Home

Type- B - 1600 Sft



- Dimension may vary slightly during construction.
- Furniture and fixtures are indicative only.
- All Dimensions are in centimeters.



Type- B - 1600 Sft  
Ground Floor

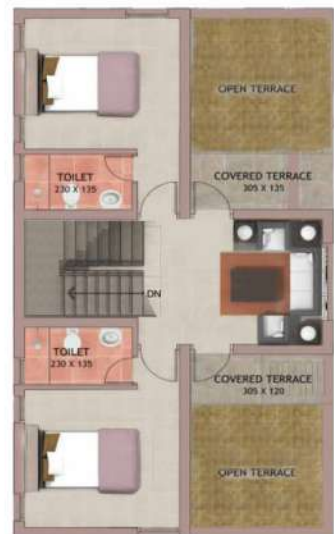

Type- B - 1600 Sft  
First Floor



# EAST AVENUE

Realizing Your Dream Home

THE  
EVERLASTING  
CREATIONS...



Aerial View



# EAST AVENUE

Realizing Your Dream Home



Layout Plan



# EAST AVENUE

Realizing Your Dream Home



**MODULAR KITCHEN & INTERIORS**

contact: **+91 9895 533 566**

 **Chothy's**<sup>®</sup>  
Building Promoters (P)LTD



# EAST AVENUE

Realizing Your Dream Home

Site in the suburbs of Thiruvananthapuram city -  
our new venture **Chothy's EAST AVENUE** has all the elements that make  
living a pleasure bordering on luxury.

We offer you luxurious services which make every penny you invest  
realize your dreams sustainable. Making the best of both the worlds -  
the urban and pastoral, each villa has facilities on par with the best in town.

Own a **Chothy's EAST AVENUE** Luxury Villa, spent a luxuries life.

## SOME PROMINENT LAND MARKS

<i>Techno Park</i>	3.5 Km
<i>Techno City</i>	2.0 Km
<i>Air Port</i>	10 Km
<i>Veli Railway Station</i>	6.0 Km
<i>VSSC Thumba</i>	5.0 Km
<i>Marian Engineering College</i>	1.5 Km
<i>Sainik School</i>	2.0 Km
<i>Kinfra Film &amp; Video Park</i>	2.0 Km
<i>University Campus, Kariavattom</i>	4.5 Km
<i>KIMS</i>	7.0 Km
<i>Medical College Hospital</i>	9.0 Km
<i>NH 66</i>	1.5 Km

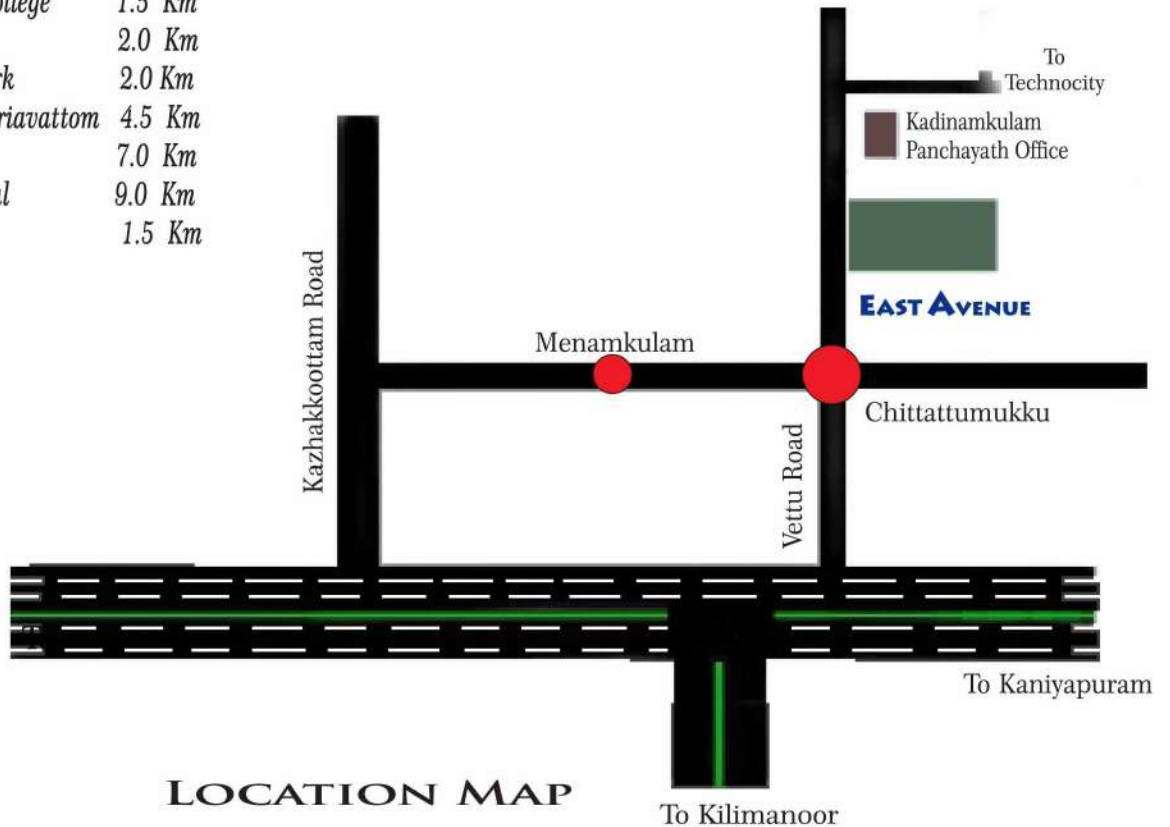

## Completed Projects



Chothis Sun View - Near Peyad



Chothis Sea Royal- Poonkulam



Chothis Galaxy - Pidaram

## Ongoing Projects

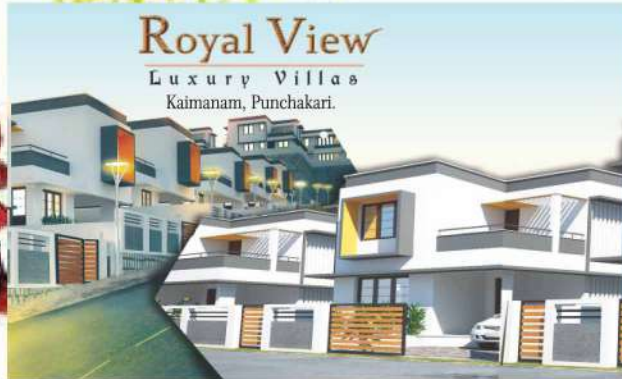

Chothis Royal View- Kaimanam- Punchakari



Chothis Green Views- Puliyaarakonam

## Upcoming Projects



Chothis ARYA - Thicaud



Chothis Nakshtra - Mudavanmugal

For more details contact:

+91 9020 263 101

+91 9020 263 103

+91 9020 263 102

+91 9020 263 105

[www.chothisbuilders.com](http://www.chothisbuilders.com)

Administrative Office

TC:71/2575(1), Killipalam Trivandrum-695036.

Tel: 0471-247 7740, 247 7741

E-mail: [chothis@hotmail.co.in](mailto:chothis@hotmail.co.in), [info@chothisbuilders.com](mailto:info@chothisbuilders.com)